

PARTS LIST			
ITEM	PART#	DESCRIPTION	NOTES
1	K2025/4025	Single Face Body w/ 6in Radius Corners	Assembly
2	K2065/75/421	Dual Frame & Cover w/ 6in Radius Corners & Covers	Assembly
10	5170	Hinge Screw	Drill 3/8" pilot hole
11	5180	Closure Screw	Drill 5/16" pilot hole

*NOTE: Drill a 3/8" oversized hole for the head of the hinge screw to slip through.

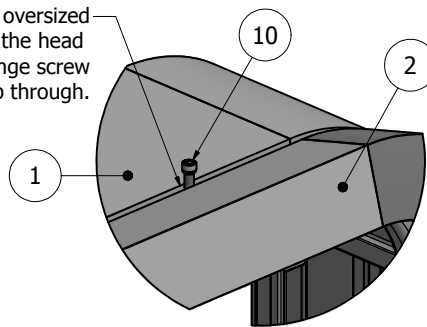

DETAIL A

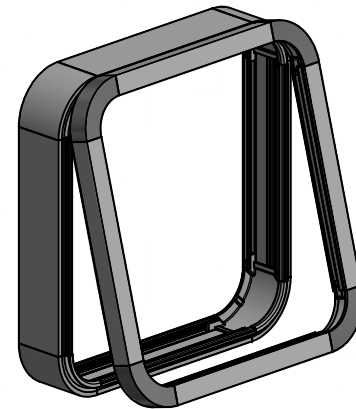

Ship To:
Sales Order#

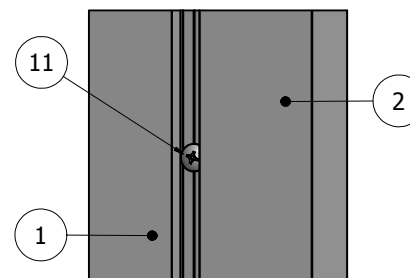
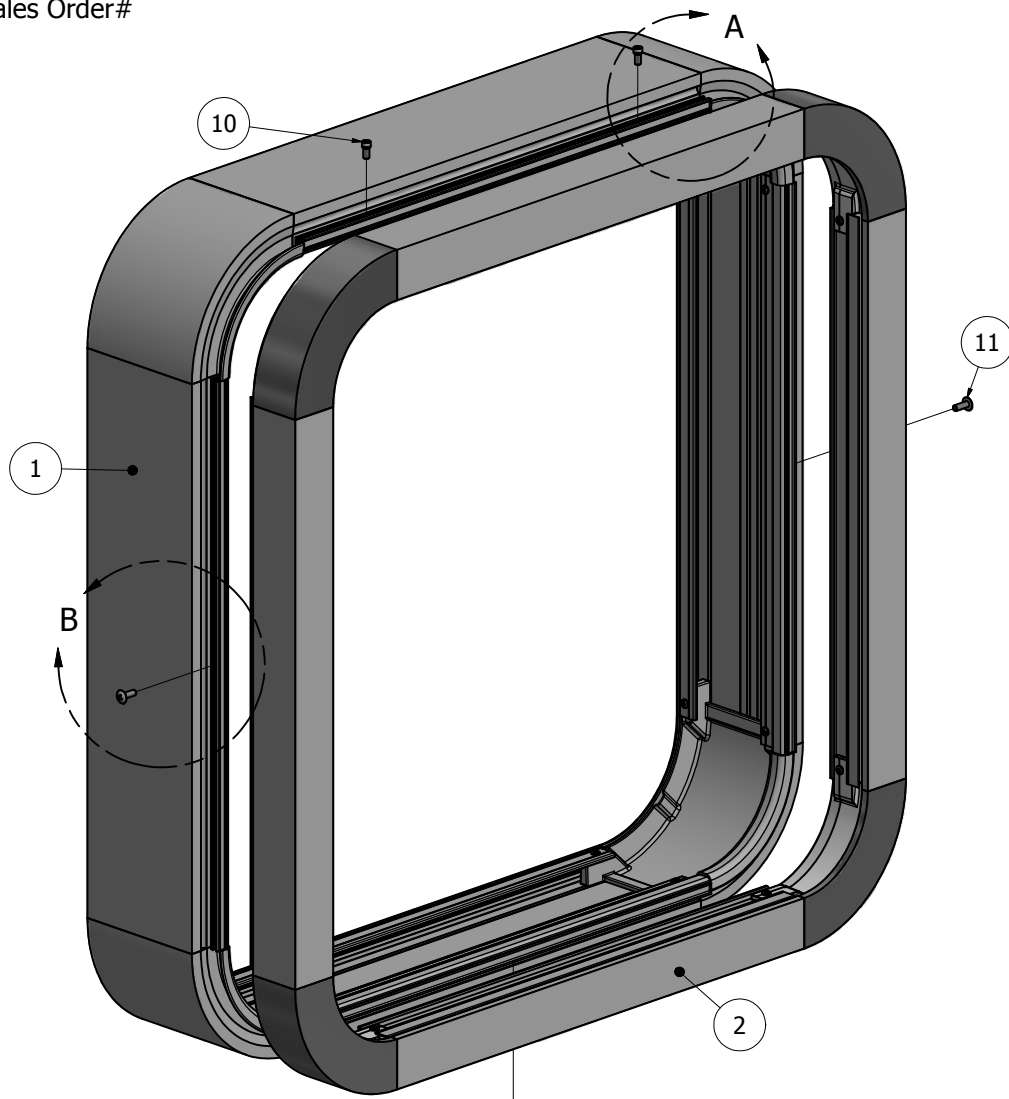

DETAIL B
FRAME CLOSED

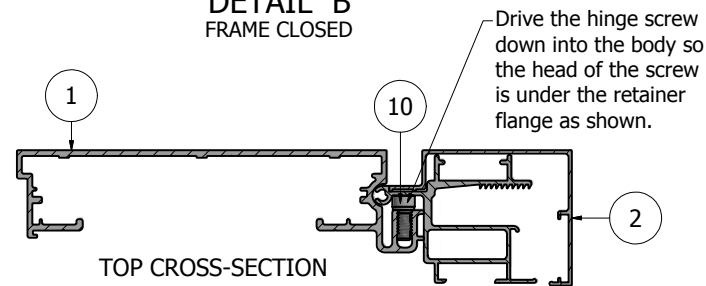

TOP CROSS-SECTION

Drive the hinge screw down into the body so the head of the screw is under the retainer flange as shown.

NOTE: PRE-CUT KITS ARE NOT PRE-DRILLED.

(Holes shown in this drawing are for reference only. Drilling of pilot holes are to be done by fabricator.)

*NOTE: IT IS RECOMMENDED THAT THE FRAME BE ASSEMBLED ON THE BODY, THEN RATCHED STRAPPED TO CHECK FOR SQUARE, BEFORE THE FRAME IS WELDED OR MECHANICALLY FASTENED.

THIS DRAWING WAS CREATED AT NO CHARGE TO ASSIST YOU IN VISUALIZING OUR PROPOSAL. THE DRAWING HEREIN IS THE PROPERTY OF SIGNCOMP. PERMISSION TO COPY OR REVISE THIS DRAWING OR TO USE THIS DRAWING FOR PRODUCTION IS STRICTLY PROHIBITED AND CAN ONLY BE COPIED, REVISED OR USED FOR PRODUCTION WITH THE EXPRESSED WRITTEN PERMISSION OF SIGNCOMP.

DRAWN	SBreihof	9/5/2012	SignComp
Centroid X:	0.000 in	TITLE	
Centroid Y:	0.000 in	Single Face Body w/ Dual Frame & 2 1/4" Dual Frame Cover and 6in Radius Corners - Assembly	
Principal Moments Ix:	0.000 in^4	DWG NO	KSF/65/75/4575
Principal Moments Iy:	0.000 in^4	REV	
Section Modulus Ix:	0.000 in^3	SHEET 1 OF 1	
Section Modulus Iy:	0.000 in^3		

PARTS LIST			
ITEM	PART#	DESCRIPTION	NOTES
1	2025	Single Face Body	Top & Bottom
2	2025	Single Face Body	Sides
3	4025	Single Face Body 6in Radius Corner	
65	5218	Radius Corner Screw	Drill 5/32" pilot hole

Ship To:
Sales Order#

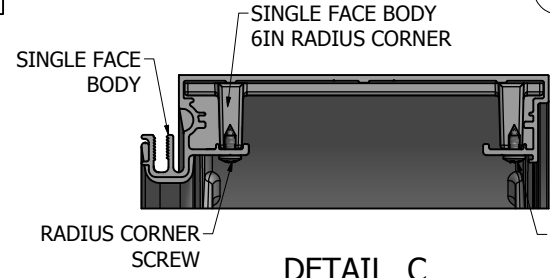
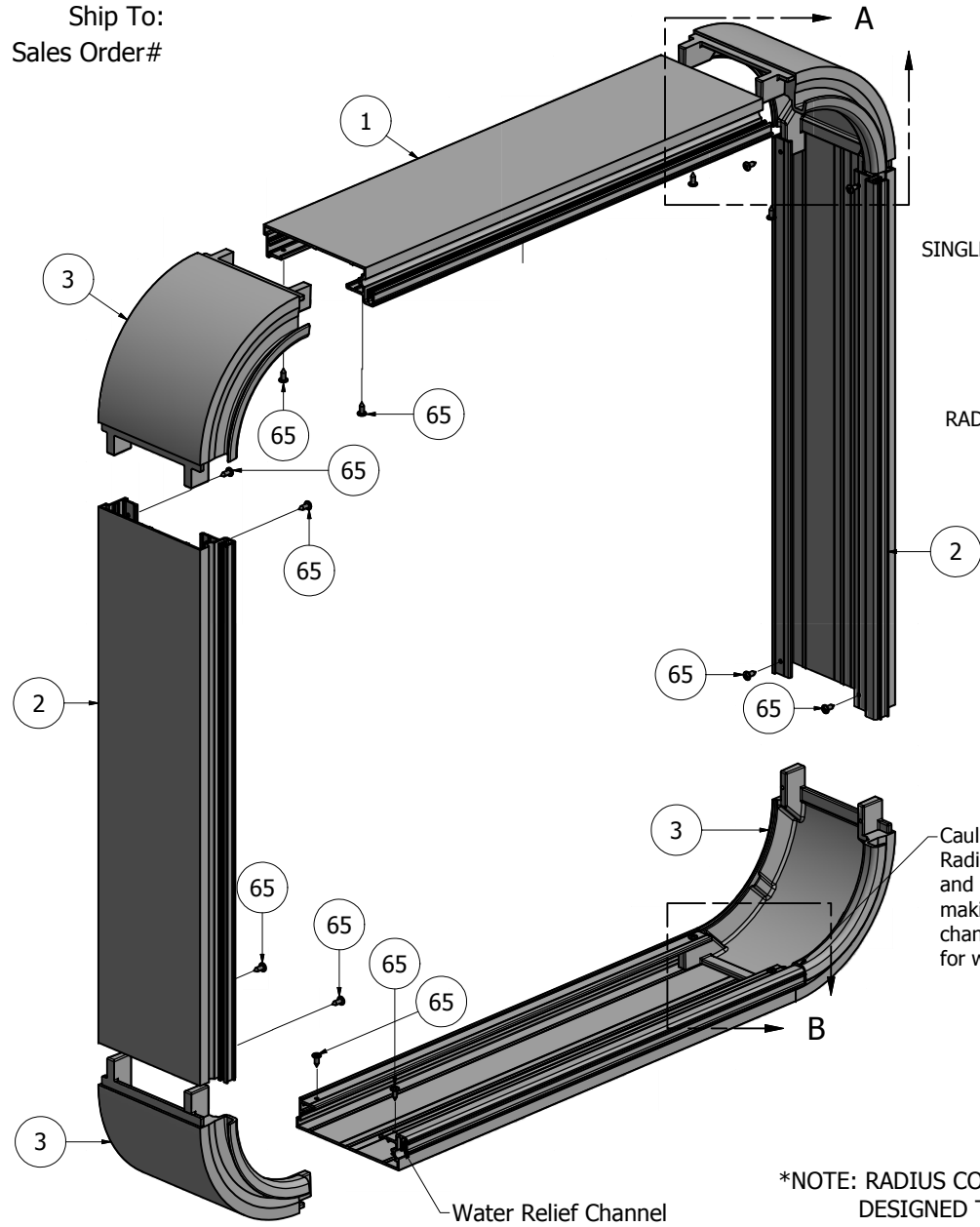

DETAIL C
CROSS-SECTION

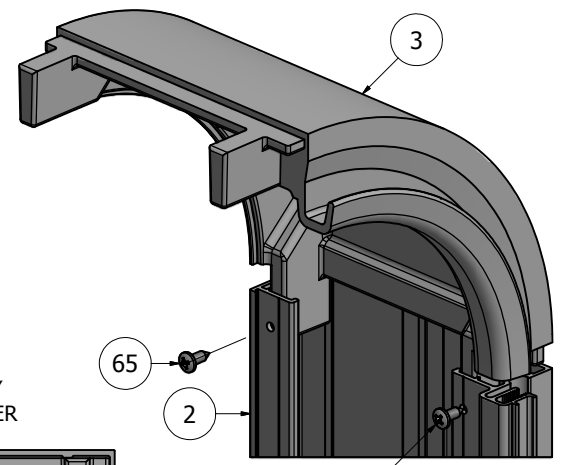

DETAIL A

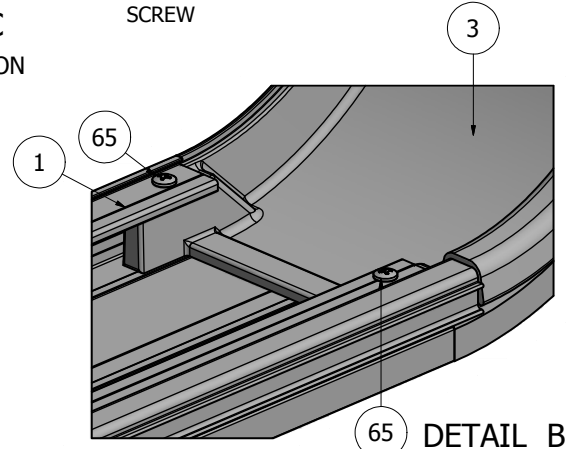

DETAIL B

Caulk the joints where the Radius Diecast Corners and the Extrusion meet, yet making sure the water relief channel is not blocked, allowing for water to flow.

NOTE: PRE-CUT KITS ARE NOT PRE-DRILLED.
(Holes shown in this drawing are for reference only. Drilling of pilot holes are to be done by fabricator.)

*NOTE: RADIUS CORNERS ARE DESIGNED TO BE WELDED, HOWEVER CAN ALSO BE MECHANICALLY ASSEMBLED.

THIS DRAWING WAS CREATED AT NO CHARGE TO ASSIST YOU IN VISUALIZING OUR PROPOSAL. THE DRAWING HEREIN IS THE PROPERTY OF SIGNCOMP. PERMISSION TO COPY OR REVISE THIS DRAWING OR TO USE THIS DRAWING FOR PRODUCTION IS STRICTLY PROHIBITED AND CAN ONLY BE COPIED, REVISED OR USED FOR PRODUCTION WITH THE EXPRESSED WRITTEN PERMISSION OF SIGNCOMP.

DRAWN	SBreihof	9/4/2012
Centroid X:	0.000 in	
Centroid Y:	0.000 in	
Principal Moments Ix:	0.000 in ⁴	
Principal Moments Iy:	0.000 in ⁴	
Section Modulus Ix:	0.000 in ³	
Section Modulus Iy:	0.000 in ³	

SignComp		TITLE
		Single Face Body w/ 6in Radius Corners - Assembly
DWG NO	KSF-4025	REV
SHEET 1 OF 1		

PARTS LIST			
ITEM	PART#	DESCRIPTION	NOTES
1	2065	Dual Frame	Top & Bottom
2	2065	Dual Frame	Sides
3	4210	Dual Frame 6in Radius Corner	
65	5218	Radius Corner Screw	Drill 5/32" pilot hole

Ship TO:
Sales Order#

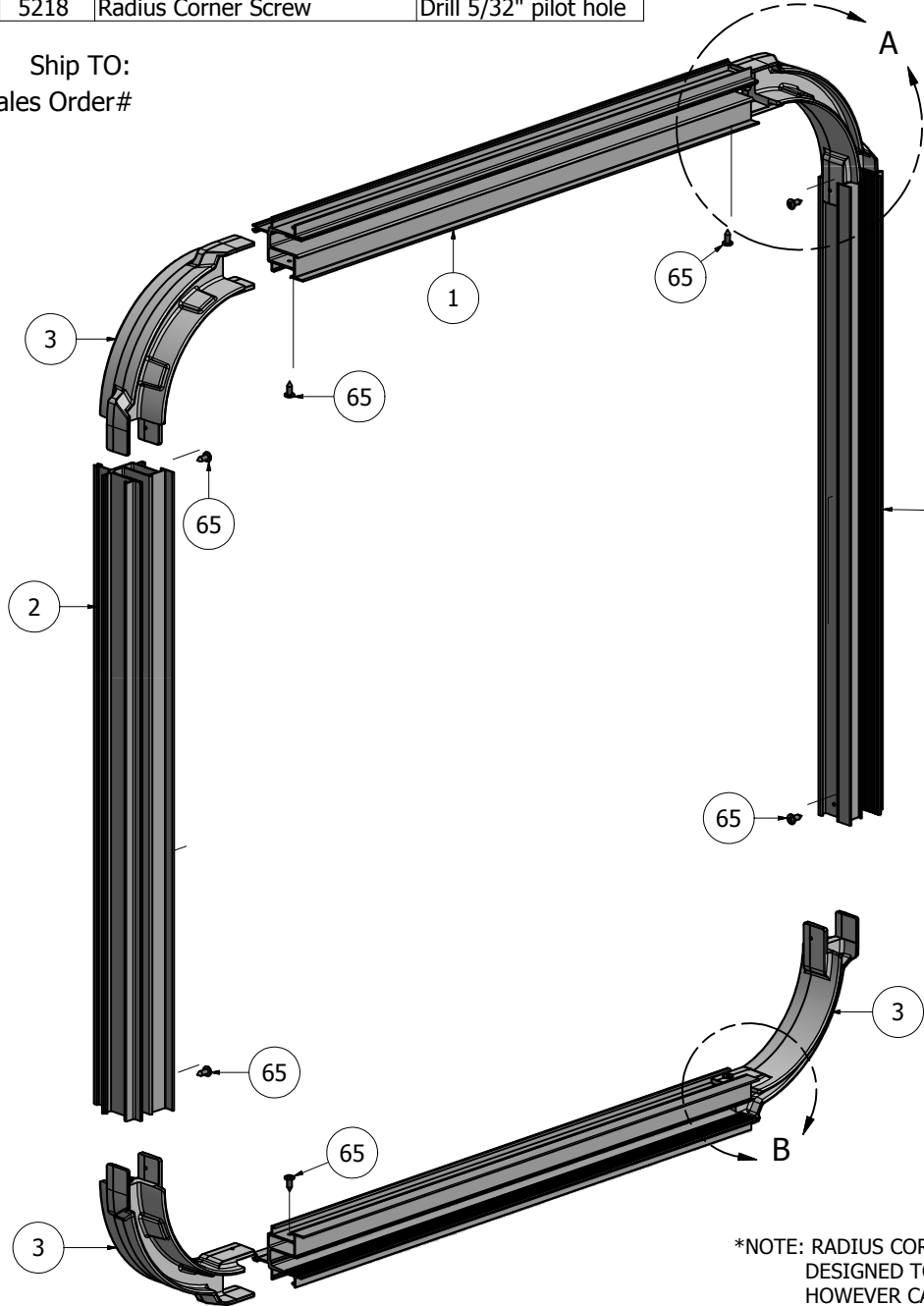

6IN RADIUS CORNER

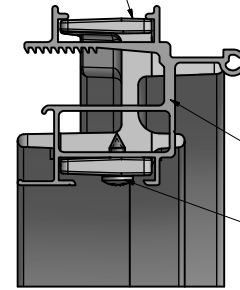

DETAIL C
CROSS-SECTION

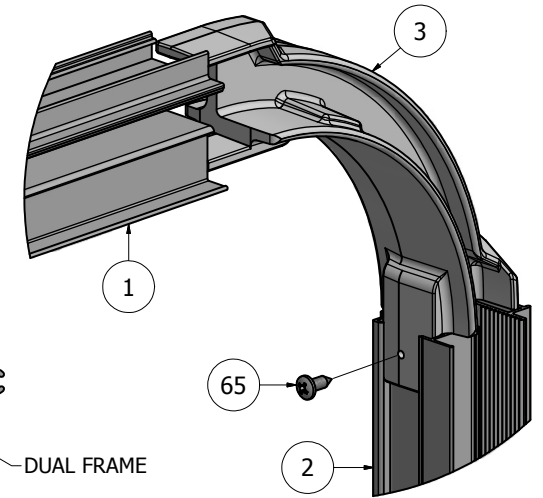

DETAIL A

*NOTE: GAPS ON BOTH SIDES OF THE RADIUS CORNER TABS ARE REQUIRED FOR PROPER ASSEMBLY.

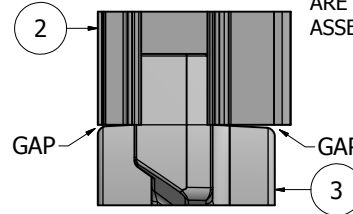

DETAIL B-2

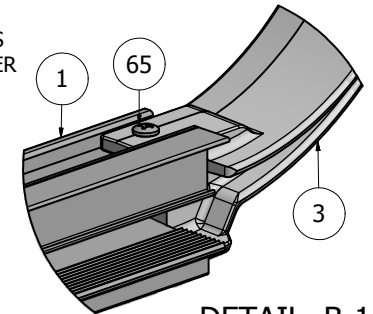

DETAIL B-1

NOTE: PRE-CUT KITS ARE NOT PRE-DRILLED.

(Holes shown in this drawing are for reference only.
Drilling of pilot holes are to be done by fabricator.)

*NOTE: RADIUS CORNERS ARE DESIGNED TO BE WELDED, HOWEVER CAN ALSO BE MECHANICALLY ASSEMBLED.

THIS DRAWING WAS CREATED AT NO CHARGE TO ASSIST YOU IN VISUALIZING OUR PROPOSAL. THE DRAWING HEREIN IS THE PROPERTY OF SIGNCOMP. PERMISSION TO COPY OR REVISE THIS DRAWING OR TO USE THIS DRAWING FOR PRODUCTION IS STRICTLY PROHIBITED AND CAN ONLY BE COPIED, REVISED OR USED FOR PRODUCTION WITH THE EXPRESSED WRITTEN PERMISSION OF SIGNCOMP.

DRAWN	SBreihof	9/5/2012	SignComp
Centroid X:	0.000 in	TITLE	
Centroid Y:	0.000 in	Dual Frame with 6in Radius Corner - Assembly	
Principal Moments Ix:	0.000 in ⁴	DWG NO	REV
Principal Moments Iy:	0.000 in ⁴	2065-4210	
Section Modulus Ix:	0.000 in ³	SHEET 1 OF 1	
Section Modulus Iy:	0.000 in ³		

PARTS LIST			
ITEM	PART#	DESCRIPTION	NOTES
1	2065/4210	Dual Frame with 6in Radius Corners	Assembly
2	2075	2 1/4" Dual Frame Cover	Top & Bottom
3	2075	2 1/4" Dual Frame Cover	Sides
4	4225P	6in Dual Frame Radius Cover	
12	5195	Cover Screw	Pre-drill 3/32" hole

Ship To:
Sales Order#

D

C

B

A

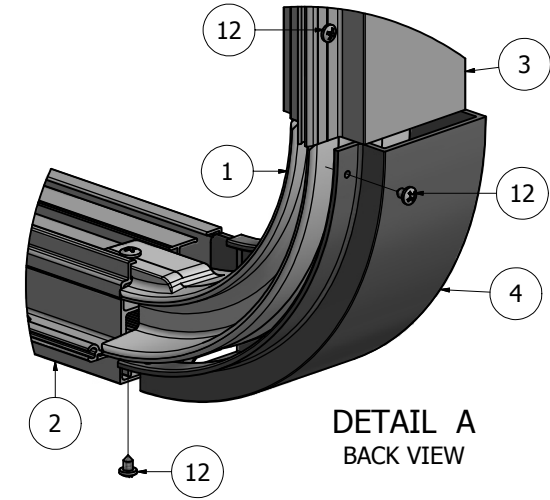
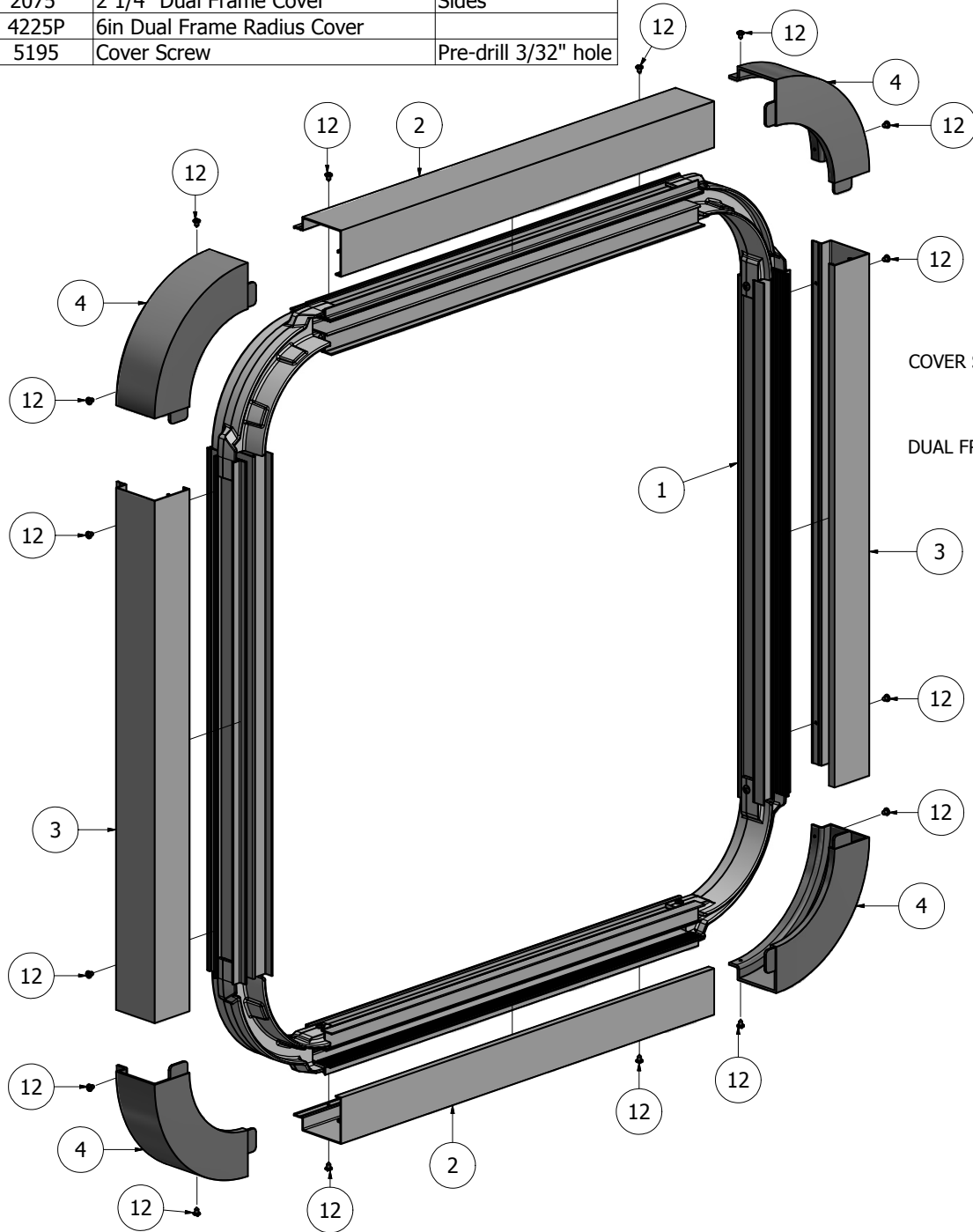

DETAIL A
BACK VIEW

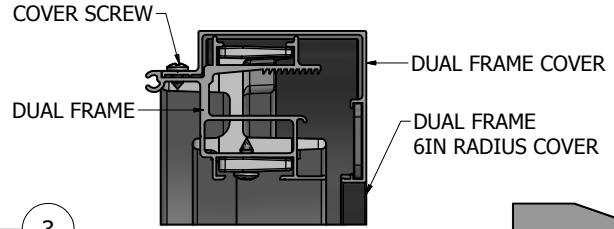

DETAIL C
CROSS-SECTION

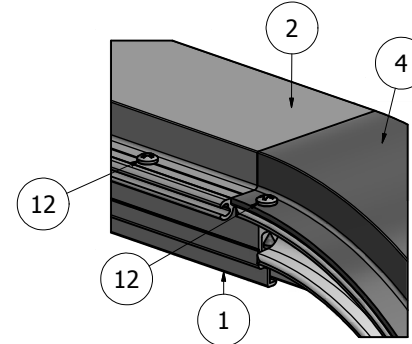

DETAIL B
BACK VIEW

NOTE: PRE-CUT KITS ARE NOT PRE-DRILLED.
(Holes shown in this drawing are for reference only.
Drilling of pilot holes are to be done by fabricator.)

THIS DRAWING WAS CREATED AT NO CHARGE TO ASSIST YOU IN VISUALIZING OUR PROPOSAL. THE DRAWING HEREIN IS THE PROPERTY OF SIGNCOMP. PERMISSION TO COPY OR REVISE THIS DRAWING OR TO USE THIS DRAWING FOR PRODUCTION IS STRICTLY PROHIBITED AND CAN ONLY BE COPIED, REVISED OR USED FOR PRODUCTION WITH THE EXPRESSED WRITTEN PERMISSION OF SIGNCOMP.

DRAWN	SBreihof	9/5/2012
Centroid X:	0.000 in	
Centroid Y:	0.000 in	
Principal Moments Ix:	0.000 in ⁴	
Principal Moments Iy:	0.000 in ⁴	
Section Modulus Ix:	0.000 in ³	
Section Modulus Iy:	0.000 in ³	

SignComp

TITLE
**Dual Frame and 2 1/4" Dual Frame Cover w/
6in Radius Corner Cover - Assembly**

DWG NO
K2065-75-4225P

REV

SHEET 1 OF 1